

Plat of Survey

of
Proposed Easements

between
Tax Parcels ZOP 00389 & ZOP 00389F
being

Part of Sublot 15 of Large Lot 4 of the Original
Plat of the Village of Lake Geneva,

located in Government Lot 3 and the Northeast 1/4 of the Southeast 1/4 of Section 36,
Town 2 North, Range 17 East, City of Lake Geneva, Walworth County, Wisconsin.

Legal Description of Proposed Easement on Tax Parcel ZOP 00389 for ZOP 00389F

Part of Sublot 15 of Large Lot 4 of the Original Plat of the Village of Lake Geneva,
located in Government Lot 3 and the Northeast 1/4 of the Southeast 1/4 of Section 36,
Town 2 North, Range 17 East, City of Lake Geneva, Walworth County, Wisconsin,
described as follows: Commence at the East 1/4 corner of said Section 36; thence South
65°27'31" West 1513.26 feet to an iron pipe at the Southwest Corner of Sublot 15 of
Large Lot 4; thence North 0°26'52" West, along the East line of Wells Street, 346.12
feet to an iron rod and the Point of Beginning; thence continue North 0°26'52" West,
along said East line, 47.00 feet to an iron pipe; thence South 55°00'00" East 72.47
feet to an iron pipe; thence South 84°44'17" West 59.25 feet to the Point of Beginning.

Said parcel contains 0.032 acre (1,387 sq.ft.) of land, more or less.

Legal Description of Proposed Easement on Tax Parcel ZOP 00389F for ZOP 00389

Part of Sublot 15 of Large Lot 4 of the Original Plat of the Village of Lake Geneva,
located in Government Lot 3 and the Northeast 1/4 of the Southeast 1/4 of Section 36,
Town 2 North, Range 17 East, City of Lake Geneva, Walworth County, Wisconsin,
described as follows: Commence at the East 1/4 corner of said Section 36; thence South
65°27'31" West 1513.26 feet to an iron pipe at the Southwest Corner of Sublot 15 of
Large Lot 4; thence North 0°26'52" West, along the East line of Wells Street, 346.12
feet to an iron rod; thence North 84°44'17" East 59.25 feet to an iron pipe and the
Point of Beginning; thence continue North 84°44'17" East 17.78 feet to an iron rod;
thence South 40°28'42" East 63.26 feet to an iron pipe; thence North 45°33'32" West
26.63 feet to an iron pipe; thence North 55°00'00" West 48.53 feet to the Point of
Beginning.

Said parcel contains 0.008 acre (353 sq.ft.) of land, more or less.

Surveyed for: **Oak Terrace Apartments**
311 South Wells Street
Lake Geneva, Wisconsin. 53147

**Tax Parcel
ZOP 00389**

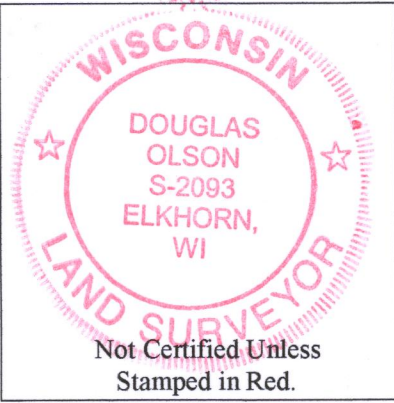
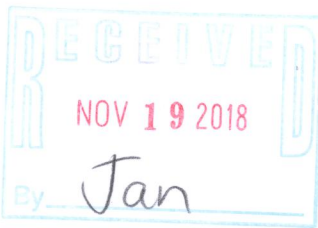

Notes:

- 1) This Plat of Survey is not certified unless signed and sealed in red ink.
- 2) This survey is subject to Wisconsin lien laws. This Plat of Survey is the notice of intent to file lien. Lien waiver required.
- 3) The Survey Date shown on this Plat of Survey is the completion date of the field work.

Copyright© 2018 by Olson Land Surveying, LLC.

All rights reserved. No part of this survey plat may be reproduced or transmitted in any form by any means - graphic, electronic, or mechanical, including photocopying, tracing, or information storage and retrieval systems - without permission in writing from Douglas G. Olson, Olson Land Surveying, LLC.

I hereby certify that I have surveyed the above described property in compliance with Chapter A-E 7 of the Wisconsin Administrative Code and that the map hereon is correct to the best of my professional knowledge and belief and shows the size and location of the property, its exterior boundaries, the location and dimensions of all visible structures thereon, boundary fences, apparent easements and roadways and visible encroachments, if any.

This survey is made for the exclusive use of the present owners of the property, and also those who purchase, mortgage or guarantee title thereto, within one year from the date hereof.

Douglas G. Olson
Wisconsin Professional Land Surveyor - 2093

Cass Street
(66' Wide)

Wells Street
(66' Wide)

Bearings referenced to the East line of the Southeast 1/4 of Section 36-2-17, recorded as N0°43'28"W in the Wisconsin State Plane Coordinate System, South Zone, (NAD-27).

Coordinates are referenced to the Wisconsin State Plane Coordinate System, South Zone, (NAD-27).

Lot 1
C.S.M. 1816

**Tax Parcel
ZOP 00389**

**Tax Parcel
ZOP 00389H**

**Tax Parcel
ZOP 00389F**

**Tax Parcel
ZOP 00389B**

**Tax Parcel
ZOP 00389E**

East 1/4 Corner
Section 36-2-17
N. 218,926.72
E. 2,424,531.97

Pipe is 0.57"
W. of line.

Southeast Corner
Section 36-2-17
N. 216,283.31
E. 2,424,565.39

Sheet 1 of 1 Sheets

Drawing Name:

Job Reference Number
2018.051

Legend of Symbols & Abbreviations

- Found County Section Corner
- Found Iron Pipe
- Found Iron Rod
- Set Iron Pipe, 1" dia.
- Set Wood Lath
- Recorded Information
- Utility Pole
- Asphalt Surface
- Concrete Surface
- Gravel Surface
- North
- South
- East
- West
- In Bearings
- Degrees
- Minutes
- Seconds
- In Distances
- Feet
- Inches



45 South Wisconsin Street | P.O. Box 322
Elkhorn, Wisconsin. 53121
Telephone: (262) 723-3434
Facsimile: (262) 723-8044
Email: doug@olsonsurveying.com
Website: www.olsonsurveying.com

Scale in Feet
1" = 20'



Survey Date: May 18, 2018.
Revisions: No. 1 - Pipe set 1' off

ZOP-389

ZOP-389F

007-3506